

FILE NAME = 209627_cph_smp_As_Built.dgn
 DATE/TIME = 1/26/2016 5:07:08 PM

SIGN LEGEND	
RR SIGN	REMOVE AND RELOCATE EXISTING SIGN
+	EXISTING LOCATION
+	NEW LOCATION
R SIGN	EXISTING SIGN TO BE REMOVED
SIGN	EXISTING SIGN TO REMAIN
SIGN	PROPOSED NEW SIGN
+	EXISTING SIGN
+	PROPOSED SIGN

NOTES:
 ALL STREET NAME SIGNS SHALL HAVE THE FOLLOWING BACKGROUND COLOR:
 • CITY STREETS - BLUE BACKGROUND
 • COUNTY ROADS - GREEN BACKGROUND

ALL GROUND MOUNTED REGULATORY (EXCLUDING PARKING) AND WARNING SIGNS SHALL BE FABRICATED USING ASTM TYPE III OR IX RETROREFLECTIVE SHEETING.

ALL OVERHEAD MOUNTED SIGNS SHALL BE FABRICATED USING ASTM TYPE IX RETROREFLECTIVE SHEETING.

* ALL GROUND AND POLE MOUNTED STREET NAME SIGNS SHALL BE TWO SIGNS EACH, MOUNTED BACK-TO-BACK.

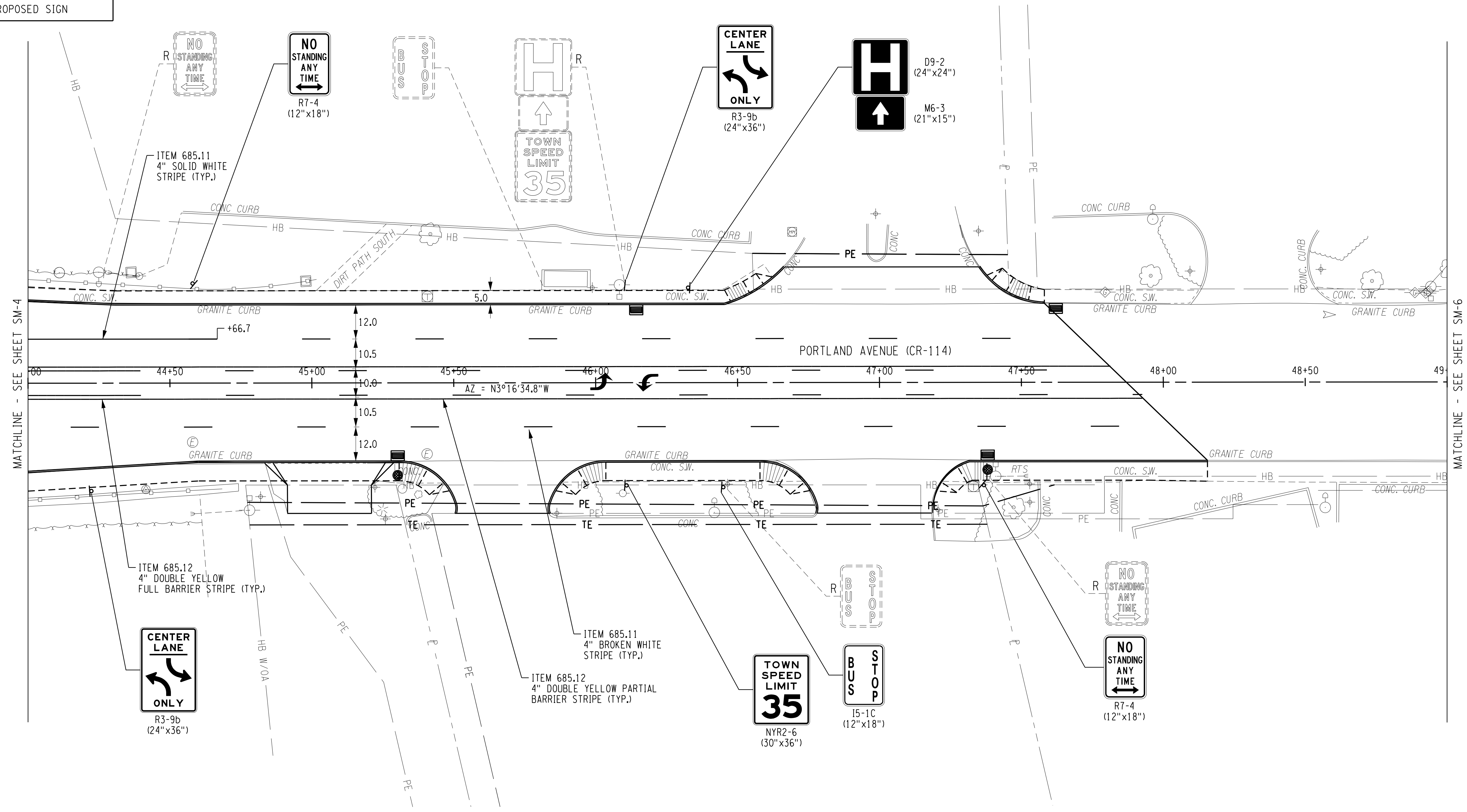
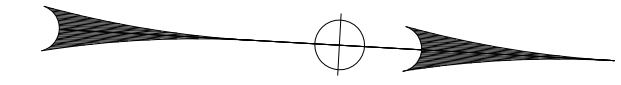

NO.	DATE	BY:	REVISION

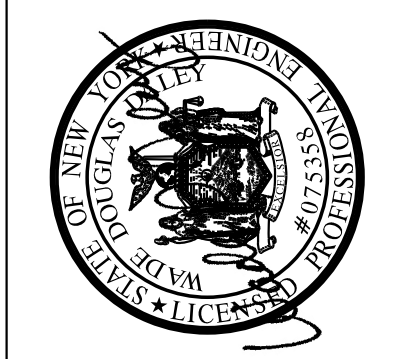

LABELLA
 Associate es.p.c.
 300 STATE STREET
 ROCHESTER, NY 14614
 P: (585) 454-6110
 F: (585) 454-3066

DEPARTMENT OF TRANSPORTATION
 50 WEST MAIN STREET, SUITE 6100
 ROCHESTER, NEW YORK 14614 - 1231
 UNAUTHORIZED ALTERATION OR ADDITION TO THIS DRAWING
 VIOLATES NEW YORK STATE EDUCATION LAW
 ARTICLE 136, SECTION 72B

PROJECT NAME	COUNTY ROAD
PORTLAND AVENUE	114
LIMITS	
PORTLAND PARKWAY TO TITUS AVENUE	
TOWN	
IRONDEQUOIT, MONROE COUNTY	
CAPITAL PROJECT NO.	NYS DOT P.I.N.
XXXX	4754.29

RECORD DRAWING

SIGNING AND PAVEMENT MARKING PLANS

SCALE: 1"=20'

DATE ISSUED: NOV 2012

DRAWING NO. SM-5

73 OF 89

I HEREBY CERTIFY BY MY SIGNATURE AND SEAL BELOW, THAT I HAVE PREPARED THIS RECORD DRAWING WHICH IS, TO THE BEST OF MY KNOWLEDGE AND IN MY PROFESSIONAL OPINION, A TRUE REPRESENTATION OF THE WORK AS CONSTRUCTED FOR THE IMPROVEMENTS TO PORTLAND AVENUE, PROJECT NO. 4754.29.